

# ANNUAL SNOWFLAKE FAIR 2021 CRAFTER APPLICATION

Groveland Congregational Church  
4 King St., Groveland, MA 01834  
978-372-3463

Friday, **November 12**, 4-8 PM & Saturday, **November 13**, 2021, 9 AM - 3 PM

We will accept applications only for crafters who are selling their own handmade items or those of a friend/family member. Crafters who resell wholesale purchased crafts or who sell non-handmade items will not be accepted (any exceptions will be made per the fair committee in advance). We will jury as much as possible.

Each space includes an 8' table and 2 chairs. There are 5 tables that are 6' (see layout on back). We also have 9 - 8' tables downstairs on the first floor. Not all spaces have access to electric outlets; please specify if you need one. Artisan/crafters will be responsible for setting up displays. Please let us know if you prefer to use your own set up that uses the same amount of space (8' x 3'). **Set up times will be listed on the confirmation mailing.**

Please review the layout on the reverse of this page. List the table(s) that you prefer on the registration. **In most cases we can accommodate your table choice. But we reserve the right to place you where we think it will be the most beneficial to all involved.**

Please disclose all items that you intend to sell so that we can place you appropriately (or we may ask that anything undisclosed beforehand be put away).

Depending on your items, you may still want to bring additional lighting – please let us know so we can set up outlets.

We will not be providing paper covering again on the tables but ask that you provide your own covers that can reach the floor in front.

Please be mindful of your surrounding table area. Be aware of your neighbor's space and the customers safe passage in front.

*GCC will be locked overnight but is not responsible for items left in the building.*

**\*Cancellations; Refunds; will only be given on or before October 15 if we can fill the table.**

\*\* Please post a link to the church on your website & don't forget Facebook, Twitter, Instagram & any other electronic media pages too!

# SNOWFLAKE FAIR CRAFTERS TABLE LAYOUT

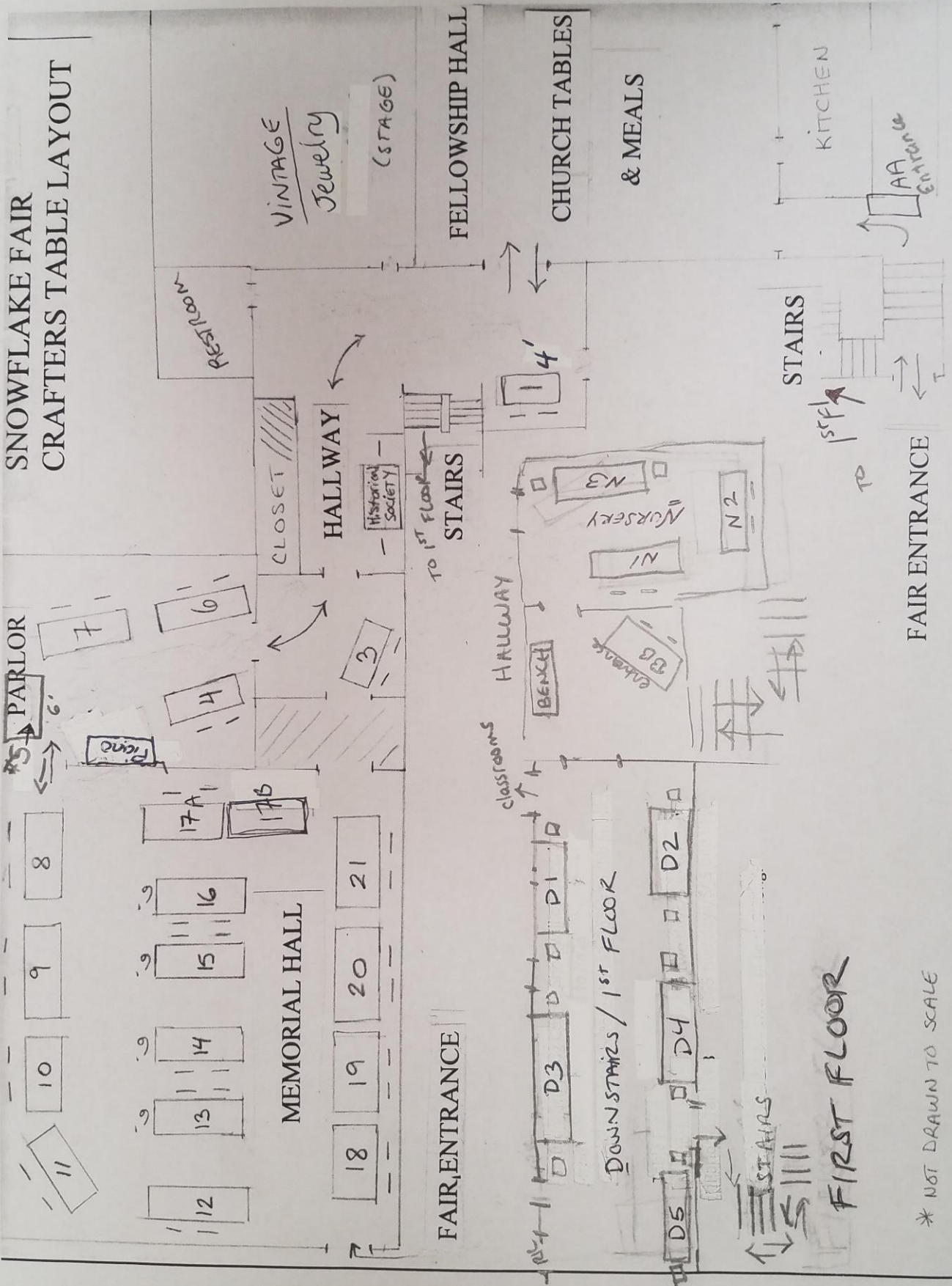

## Snowflake Fair Application 2021

Please complete the following form and mail it in with your payment by *August 31*.

**Name:** \_\_\_\_\_ **Phone:** \_\_\_\_\_

**Business name:** \_\_\_\_\_ **e-mail:** \_\_\_\_\_

**Address:** \_\_\_\_\_ **City, State, Zip** \_\_\_\_\_

**Description of items being sold (Please attach a photo if you have not attended before):**

---

---

### MAIN HALLWAY & PARLOR

\_\_\_\_\_ @ \$50 for Friday Nov. 12 or \_\_\_\_\_ @ \$50 for Saturday Nov. 13 Only      \$ \_\_\_\_\_

\_\_\_\_\_ @ \$75 for Both Friday & Saturday      \$ \_\_\_\_\_

### MEMORIAL HALL

\_\_\_\_\_ @ \$40 for Friday Nov. 12 or \_\_\_\_\_ @ \$40 for Saturday Nov. 13 Only      \$ \_\_\_\_\_

\_\_\_\_\_ @ \$65 for Both Friday & Saturday      \$ \_\_\_\_\_

### FIRST FLOOR

\_\_\_\_\_ @ \$30 for Friday Nov. 12 or \_\_\_\_\_ @ \$30 for Saturday Nov. 13 Only      \$ \_\_\_\_\_

\_\_\_\_\_ @ \$50 for Both Friday & Saturday      \$ \_\_\_\_\_

ELECTRIC OUTLET       OWN SET-UP      TOTAL ENCLOSED: \$   
(providing your own chairs or table)

**Checks Payable to** **Groveland Congregational Church**

**Please mail to: GCC, Attn: Amy Szarek, Snowflake Fair, GCC, 4 King St., Groveland, MA 01834**

---

#### Office Use Only

Date application received: \_\_\_\_\_ Payment Information: \_\_\_\_\_ Table Number: \_\_\_\_\_

Letter of Confirmation Sent: \_\_\_\_\_ Other Information: \_\_\_\_\_